

DHI-ARM982-P

Alarm Expansion Module



System Overview

The Network Expansion Module extends the communication distance between the RS-485 module and the keyboard. It pairs with the alarm control panel and supports 8-channel local alarm input and 2-channel relay output. It is easy to install, and is mainly used in scenes such as shopping malls, villas and office buildings.

Scene

It is suitable for use in places such as shops, villas and office buildings.

Technical Specification

Port

Alarm Input	8-channel digital input
Alarm Output	2-channel local relay output (≤ 30 VDC, 1 A, resistive load only)
Network Port	10 Mbps/100 Mbps self-adaptive Ethernet port, standard PoE
RS-485	Supports 2-channel RS-485 ports. A1 and B1 are used to access alarm keyboards, and A2 and B2 are used to access RS-485 expansion I/O modules.

Function

Indicator Light	1, red power supply indicator
Button	1, for restoring the device to its factory settings
Offline Cache	Max. 1024 offline data
Remote Update	Yes
Tamper	Case tamper detection

- Supports standard PoE and 12 VDC power supplies.
- 8-channel alarm input, and 2-channel relay output.
- Multiple types of zone loops such as 0EOL, 1EOL, 2EOL, and 3EOL.
- Supports 3 EOLR values: 2.7 K, 4.7 K, and 6.8 K.
- Wireless signal data can be converted into TCP/IP networking data and sent to the alarm control panel.
- Connects with up to 4 alarm keyboards and 4 expansion I/O modules through the RS-485 ports.
- Alarm data can be cached offline.
- Remote update.

Technical

Scenario	Indoors
Operating Current	<0.1 A

General

Power Supply	12 VDC/POE (802.3af)
Operating Temperature	-10 °C to +55 °C (+14 °F to +122 °F)
Operating Humidity	10%–90% (RH)
Product Dimensions	126.0 mm × 57.0 mm × 33.2 mm (4.96" × 2.24" × 1.31")
Net Weight	230 g (0.51 lb)
Gross Weight	386 g (0.85 lb)
Installation	Wall mount
Casing Material	Electro-galvanized sheet
Certifications	CE
Anti-corrosion Level	Basic Protection
Storage Temperature	-10 °C to +55 °C (+14 °F to +122 °F)
Storage Humidity	10%–90% (RH)
Packaging Dimensions	187.0 mm × 164.0 mm × 58.0 mm (7.36" × 6.46" × 2.28")

Ordering Information

Type	Model	Description
Alarm Expansion Module	DHI-ARM982-P	Alarm Expansion Module

Installation

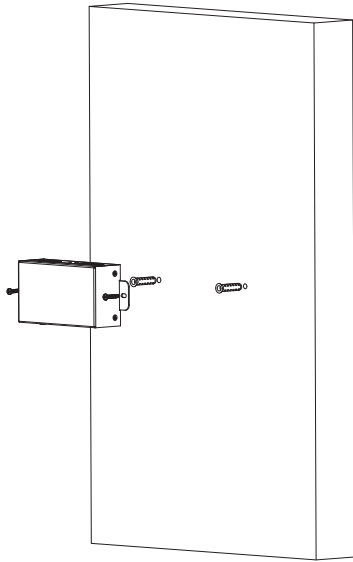

Application

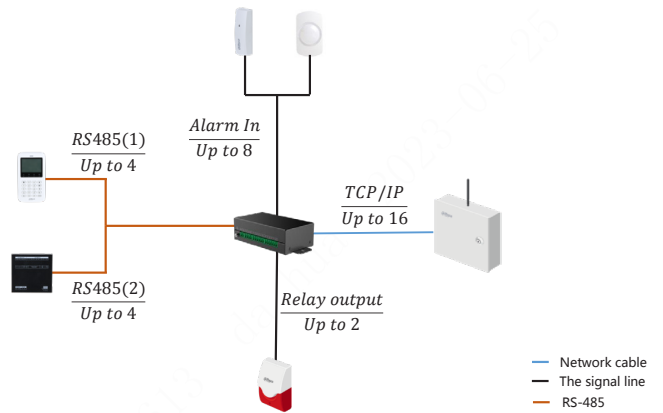

Dimensions (mm[inch])

