

Features

Manual fire alarm stations for releasing applications:

- Double action push and pull operation with a normally open (NO) contact
- Current limited model is available with series connected 560 Ω resistor for Style C operation (current limited = alarm; open or short = trouble)
- Operation complies with ADA requirements
- Pull lever protrudes when alarmed
- Break-rod is supplied (use is optional)
- Label kit provides six varieties of releasing applications (ordered separately)
- Screw terminals for wiring connections

Tamper resistant reset key lock (keyed same as Simplex fire alarm cabinets)

Multiple mounting options:

- Surface or semi-flush with standard boxes or matching Simplex boxes
- Flush mount adapter kit
- Adapters are available for retrofitting to commonly available existing boxes

UL listed to Standard 38

Operation

Double Action Push Type Manual Release Stations require that a spring loaded interference plate (marked PUSH) be pushed back to access the pull lever of the single action station, reducing the possibility of an accidental activation. A firm downward pull of the lever then activates the alarm switch, breaking an internal plastic break-rod, visible below the pull lever.

Break-rod use is optional. Use of a break-rod can provide an additional reduction of the possibility of an accidental activation without interfering with the minimum pull requirements needed for easy activation.

When activated, the pull lever latches into the alarm position and remains extended out of the housing to provide a visible indication.

Station reset requires the use of a key to reset the manual station lever and deactivate the alarm switch. If the break-rod is used, it must be replaced.

Station testing is performed by physical activation of the pull lever. Electrical testing can be also performed by unlocking the station housing to activate the alarm switch.

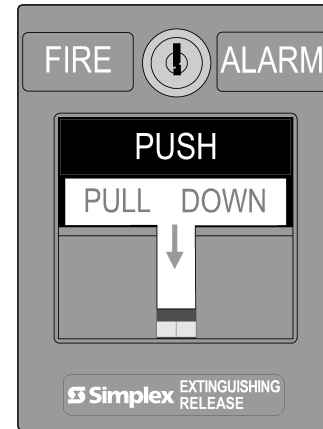

Figure 1: Double Action Push Type Manual Release Station (shown with sample release label)

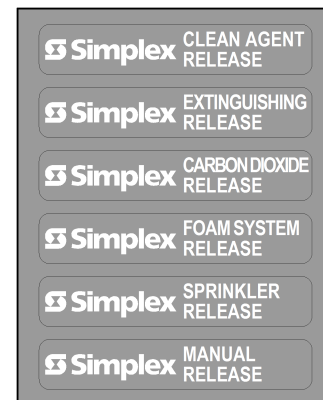

Figure 2: Label Kit 4099-9802

Label selection

A blank area on the front of the station allows the selection of a label to match the specific release application (label kit is ordered separately). Refer to data sheet [S2099-0007](#) for standard Simplex manual stations.

Product selection

Table 1: Double action, push operation, manual release stations

Model	Description
2099-9149	Standard operation, NO contact
2099-9152	For Style C operation, NO contact with series connected 560 Ω resistor
4099-9802	Label kit; select the label required for the specific release application; types include: Clean Agent, Extinguishing, Carbon Dioxide, Foam System, Sprinkler, and Manual

Table 2: Accessories

Model	Description	Reference
2975-9178	Surface mount red box	Refer to page 3 for dimensions
2975-9022	Steel Cast aluminum	
2099-9813	Semi-flush trim plate for double gang switch box, red	Typically for retrofit, refer to page 4 for details
2099-9814	Surface trim plate for Wiremold box V5744-2, red	
2099-9819	Flush mount adapter kit	Refer to page 4 for details
2099-9820	Black Beige	
2099-9804	Replacement break-rod	
252-019	B key for manual station reset	

Specifications

Wire Connections	Screw terminal for in/out wiring, for 18 AWG to 14 AWG wire (0.82 mm ² to 2.08 mm ²)
Temperature Range	32°F to 140°F (0°C to 60°C) intended for indoor operation
Humidity Range	Up to 90% RH at 90°F (38°C)
Housing Color	Red with white raised lettering
Material	Housing and pull lever are Lexan polycarbonate or equal
Pull Lever Color	White with red raised lettering
Housing Dimensions	5 in. H x 3. 3/4 in. W x 1 in. D (127 mm x 95 mm x 25 mm)
Installation Instructions	574-686

Semi-flush mounting reference

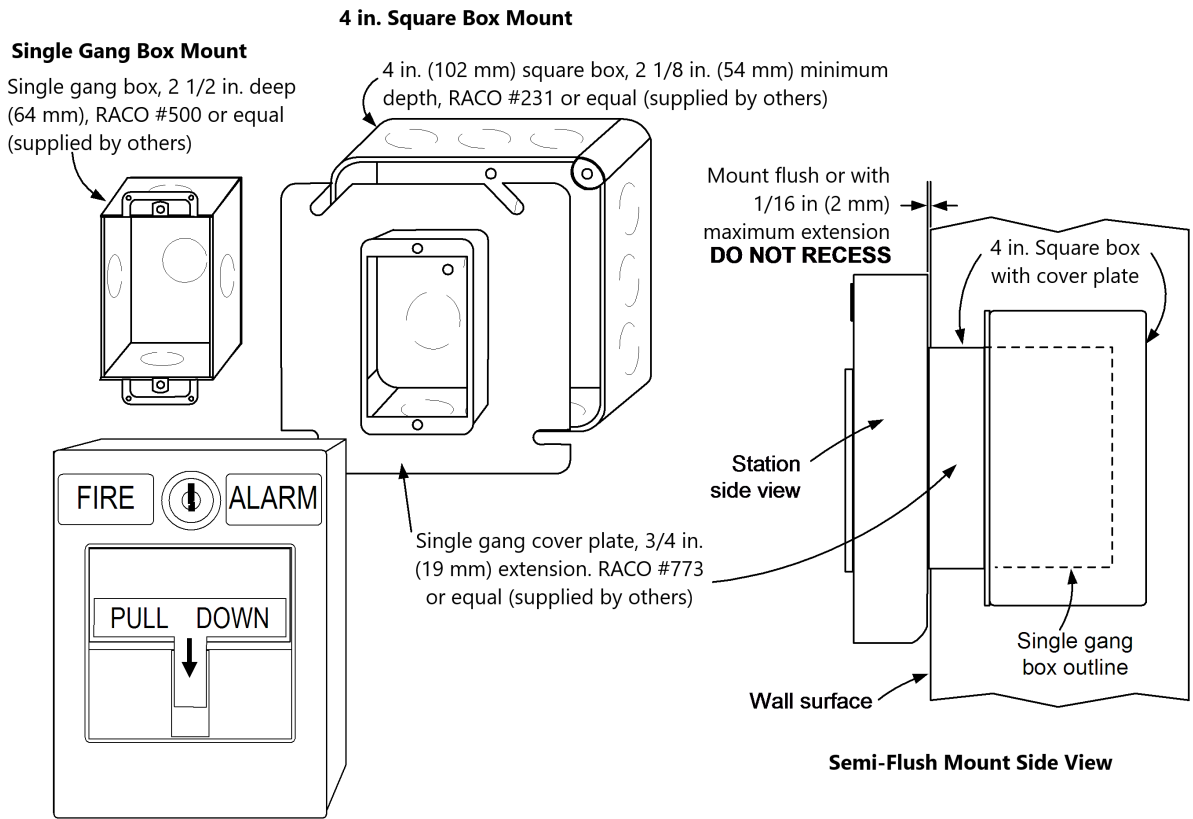

Figure 3: Semi-flush mounting reference

Surface mounting reference

Preferred mounting. For surface mounting, the preferred electrical boxes, the 2975-9178 Box and 2975-9022 Cast Box, are shown in the illustration.

Additional mounting reference. Refer to [Additional mounting information](#)

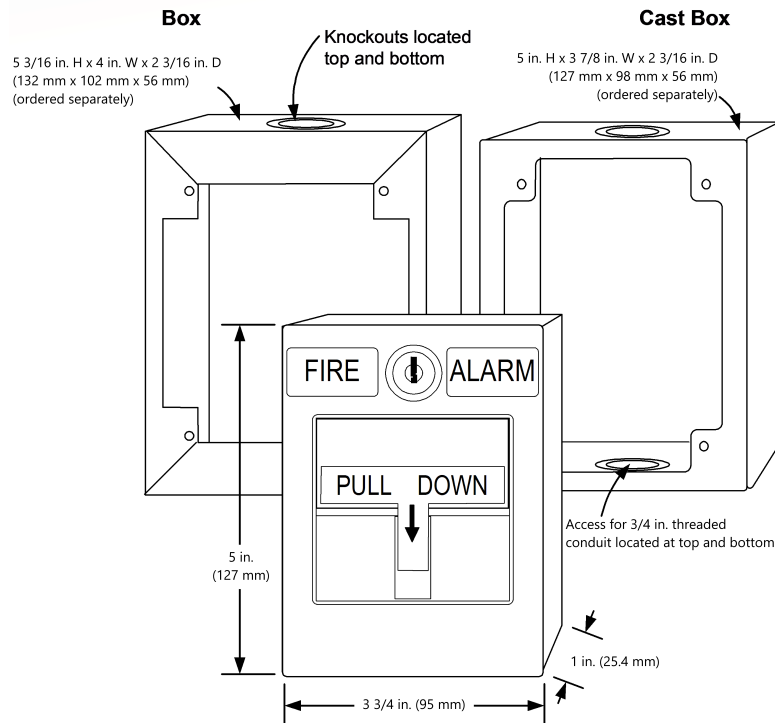

Figure 4: 2099 Series manual release station

Surface mount side view

The illustration shows the side view of the 2975-9178 box.

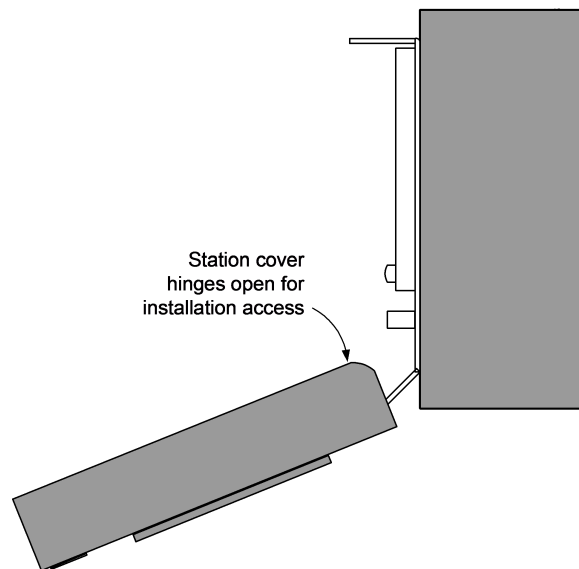

Figure 5: Surface mount side view

Additional mounting information

For retrofit and new installations, additional compatible mounting boxes and the required adapter plates (the 2099-9814 Surface trim and the 2099-9813 Semi-flush trim) are shown in the illustration.

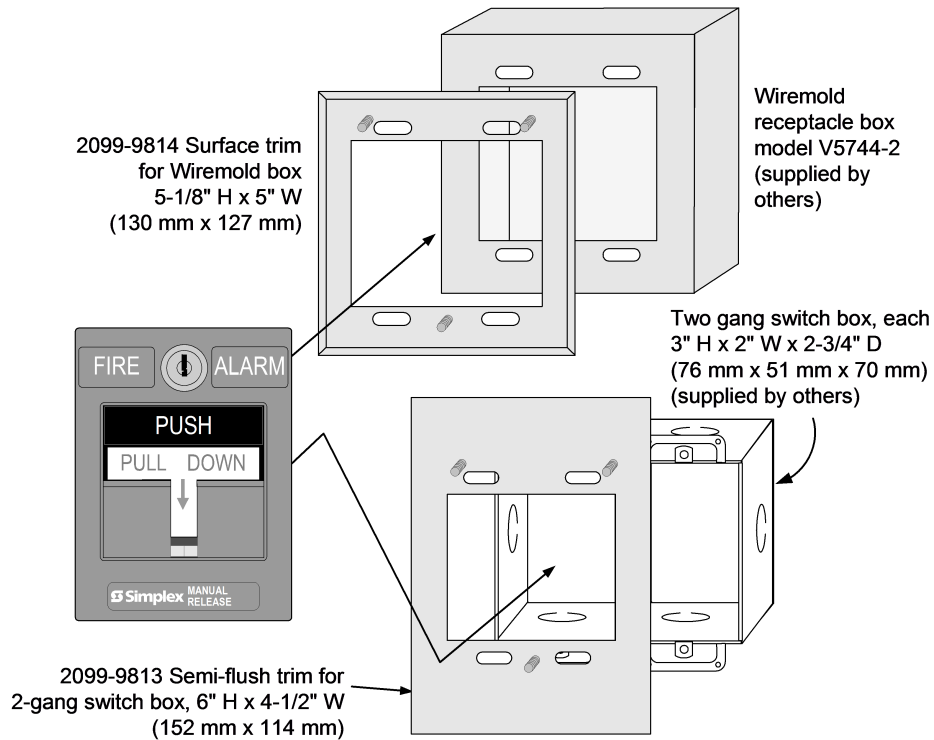

Figure 6: Additional mounting information

Flush mounting information

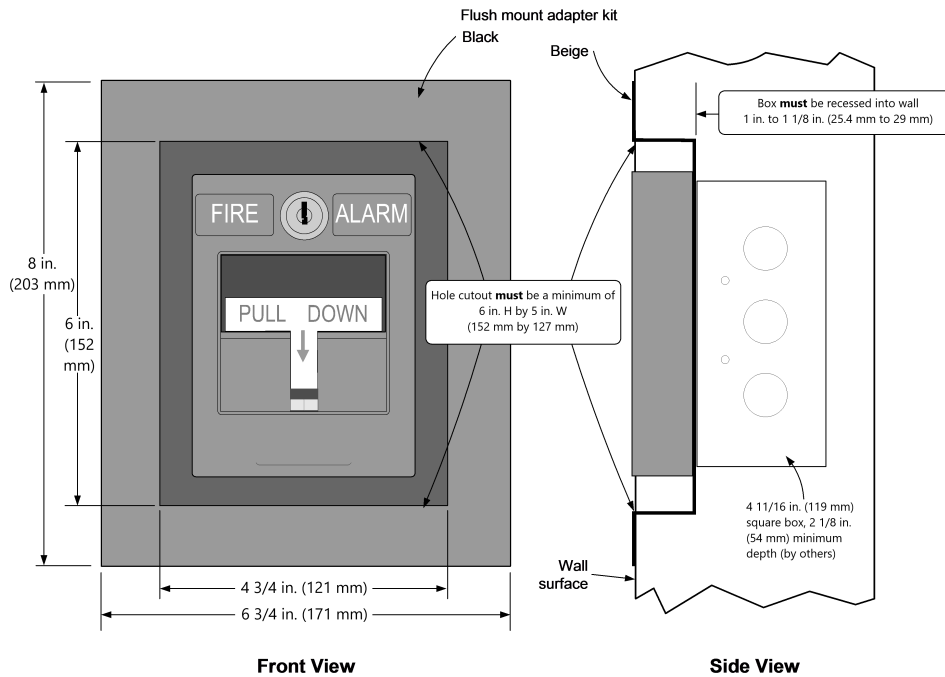

Figure 7: Flush mounting information

